

CONFERENCE SQUARE

Room Setups in the University Commons

*Please note that adding additional furniture to the room will decrease the listed capacities.

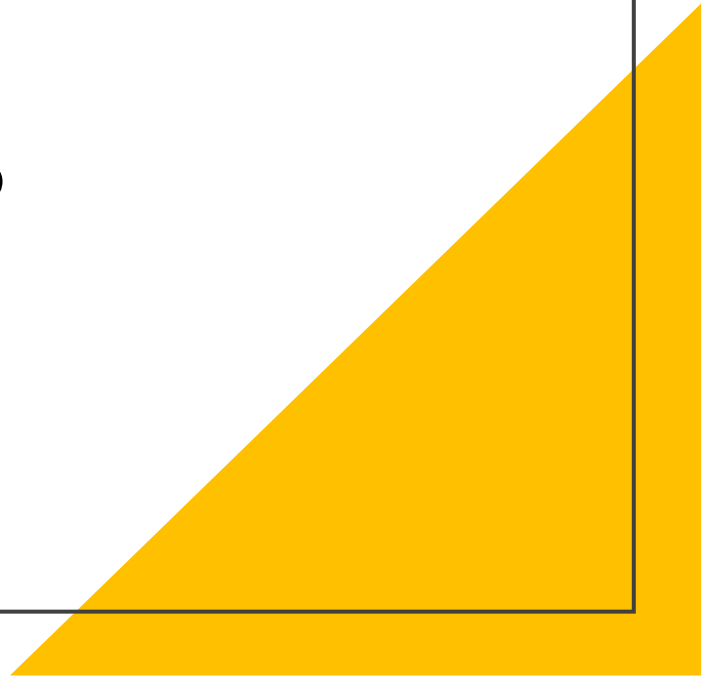

Multi-Purpose Room
Student Center, 1st Floor

CONFERENCE
SQUARE –
6FT TABLES

Capacity - 36

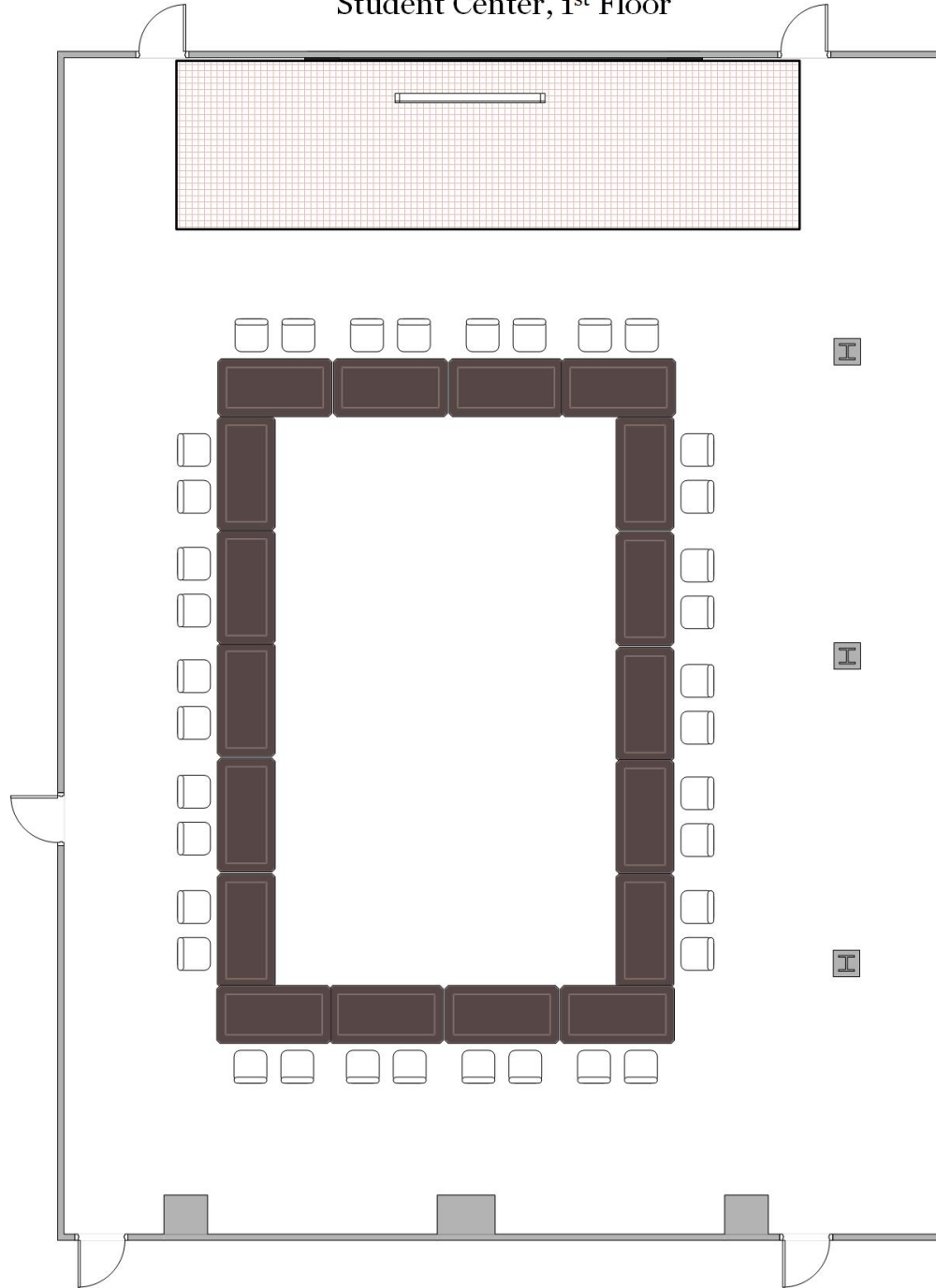

CONFERENCE SQUARE – 5FT TABLES

Diagram shows
168A and 168B as
two separate rooms

168A
Capacity - 20

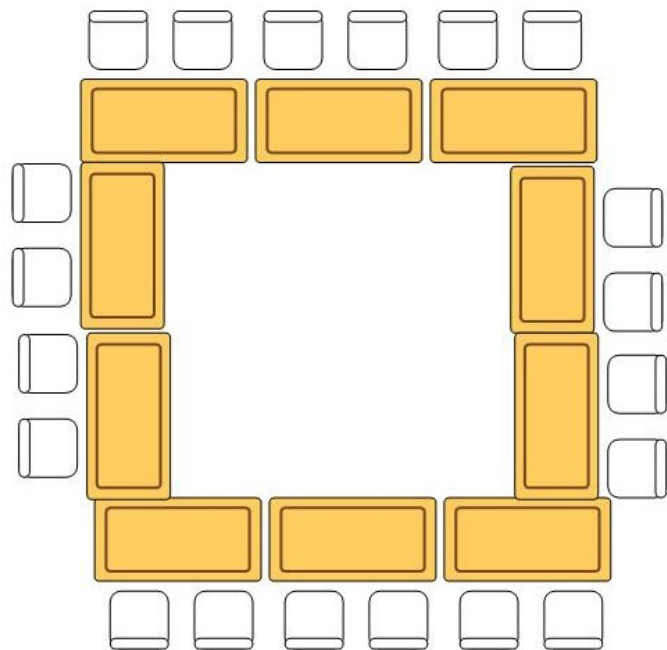

168B
Capacity - 16

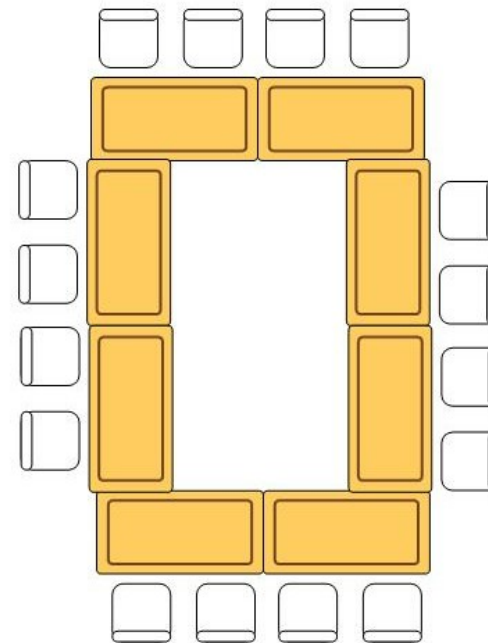

UC 168A/B
Ballroom Building, 1st Floor

CONFERENCE SQUARE – 6FT TABLES

Diagram shows
168A and 168B as
two separate rooms

168A
Capacity - 16

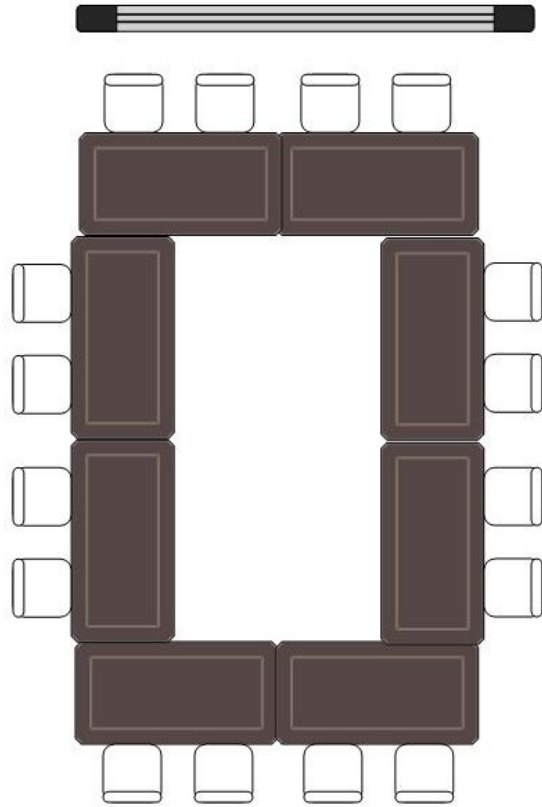

168B
Capacity - 16

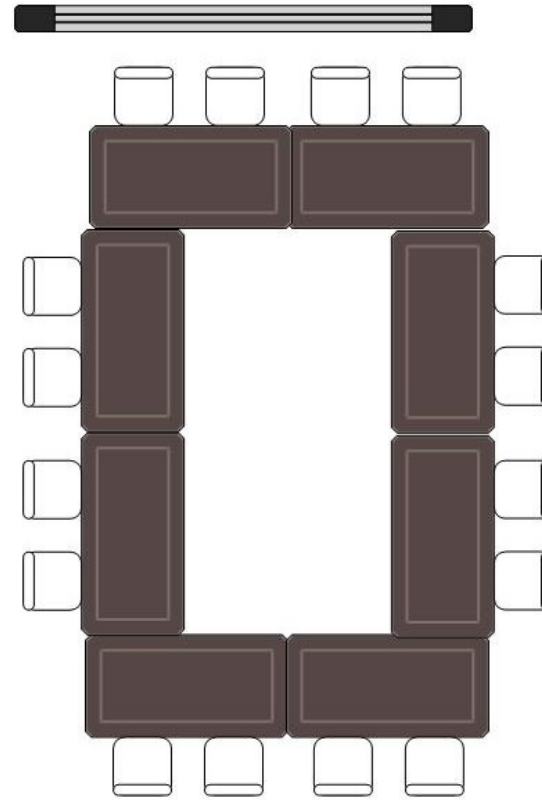

UC 168A/B
Ballroom Building, 1st Floor

CONFERENCE SQUARE – 5FT TABLES

168AB
Capacity - 36

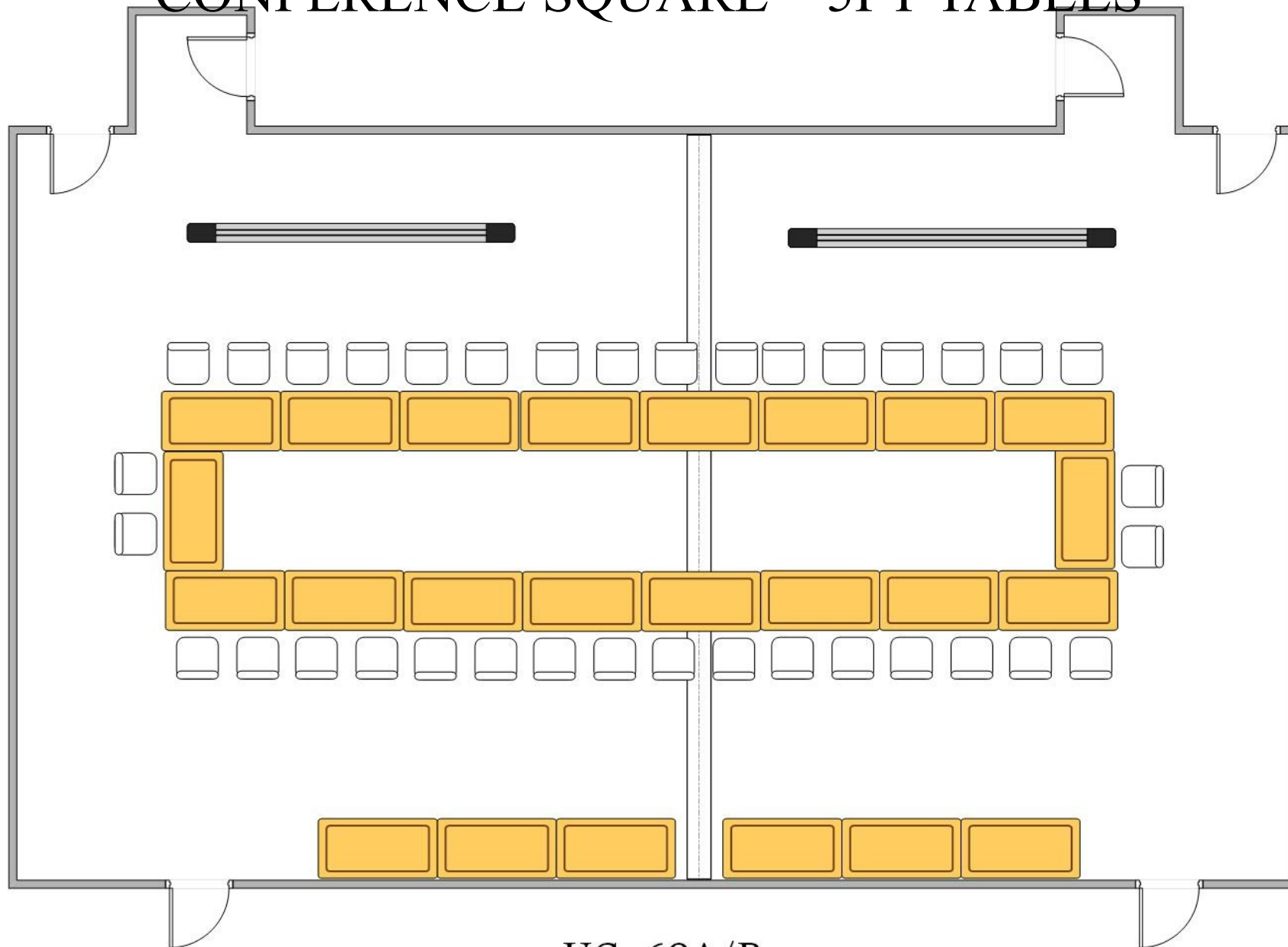

UC 168A/B
Ballroom Building, 1st Floor

CONFERENCE SQUARE – 6FT TABLES

168AB
Capacity - 28

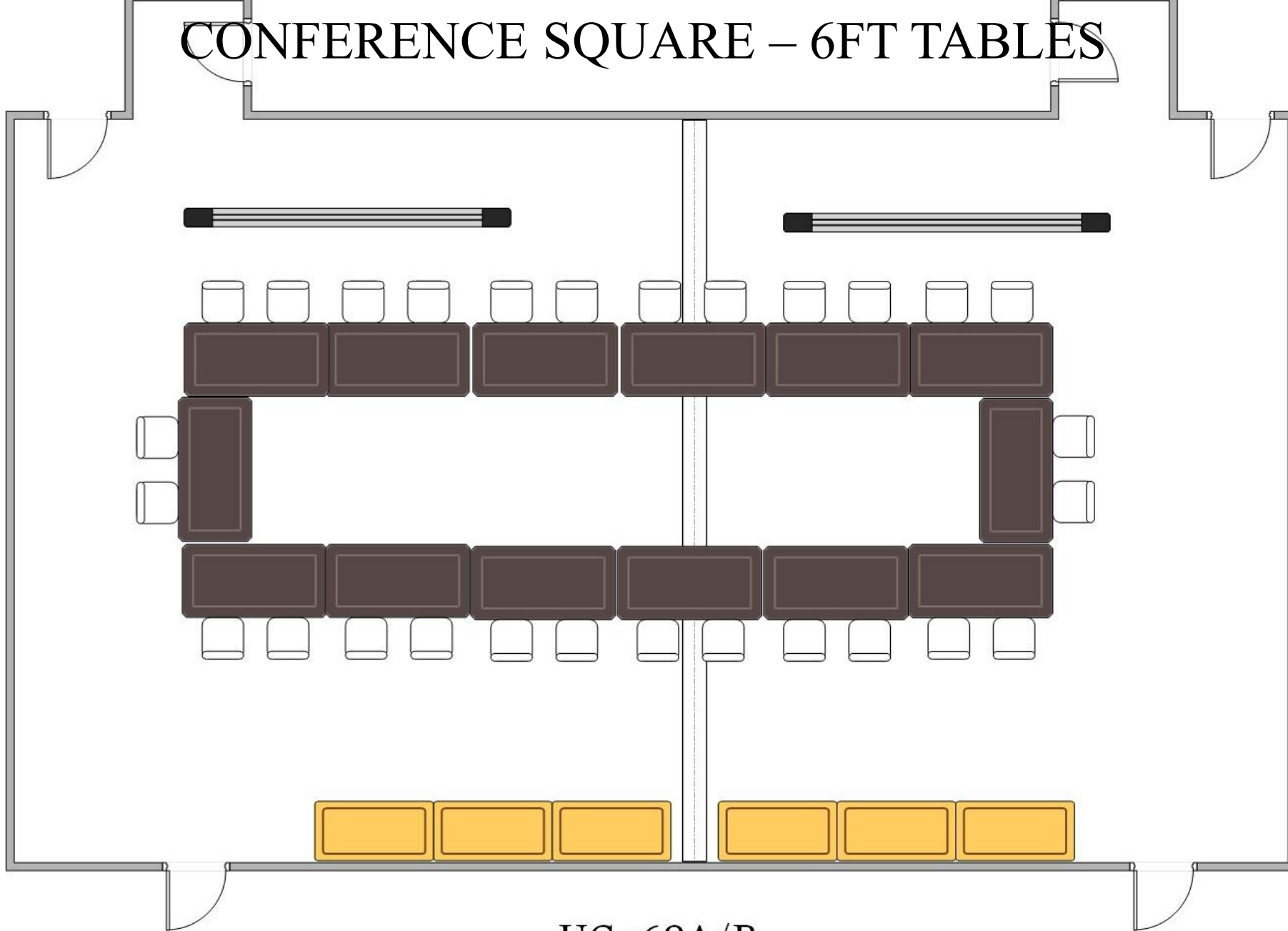

UC 168A/B
Ballroom Building, 1st Floor

Diagram shows
171A and 171B as
two separate rooms

CONFERENCE SQUARE – 5FT TABLES

171A
Capacity - 16

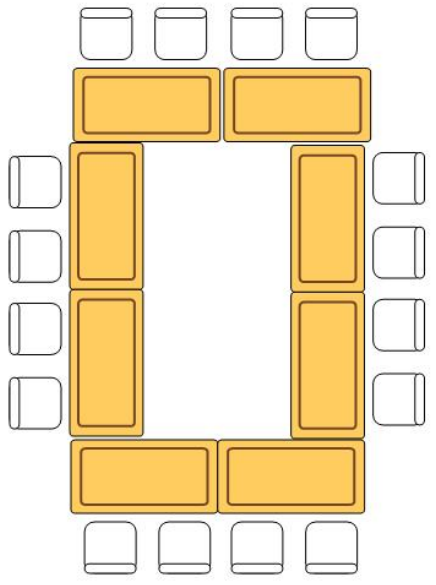

171B
Capacity - 24

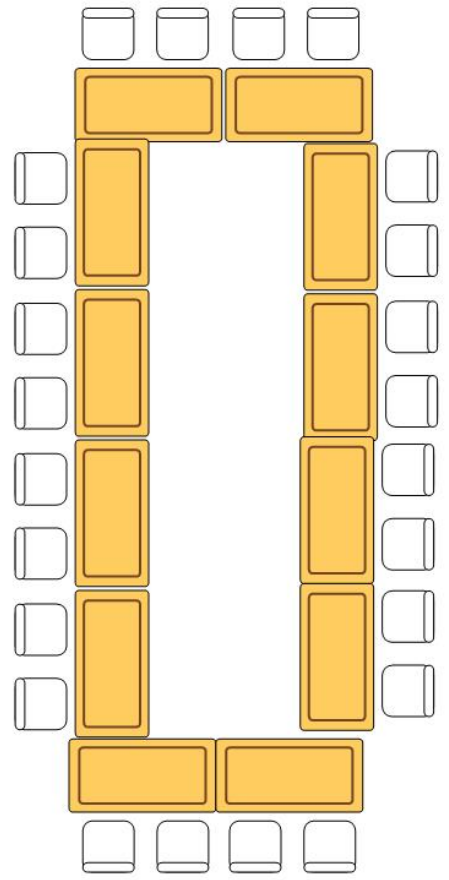

UC 171A/B
Ballroom Building, 1st Floor

CONFERENCE SQUARE – 6FT TABLES

Diagram shows
171A and 171B as
two separate rooms

171A
Capacity - 12

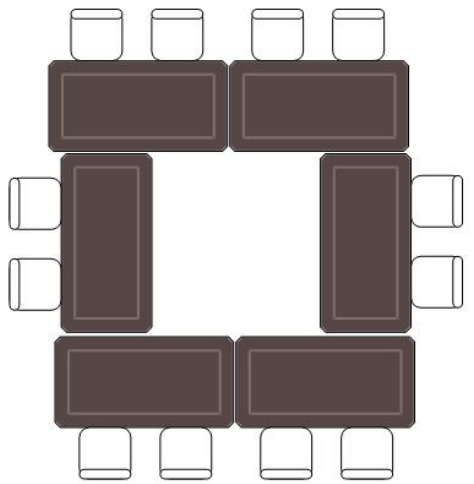

171B
Capacity - 20

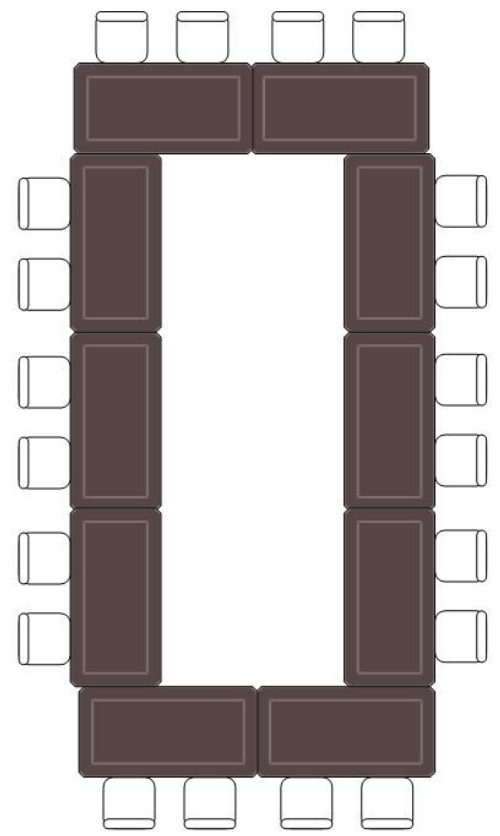

UC 171A/B
Ballroom Building, 1st Floor

CONFERENCE SQUARE – 5FT TABLES

171AB
Capacity - 36

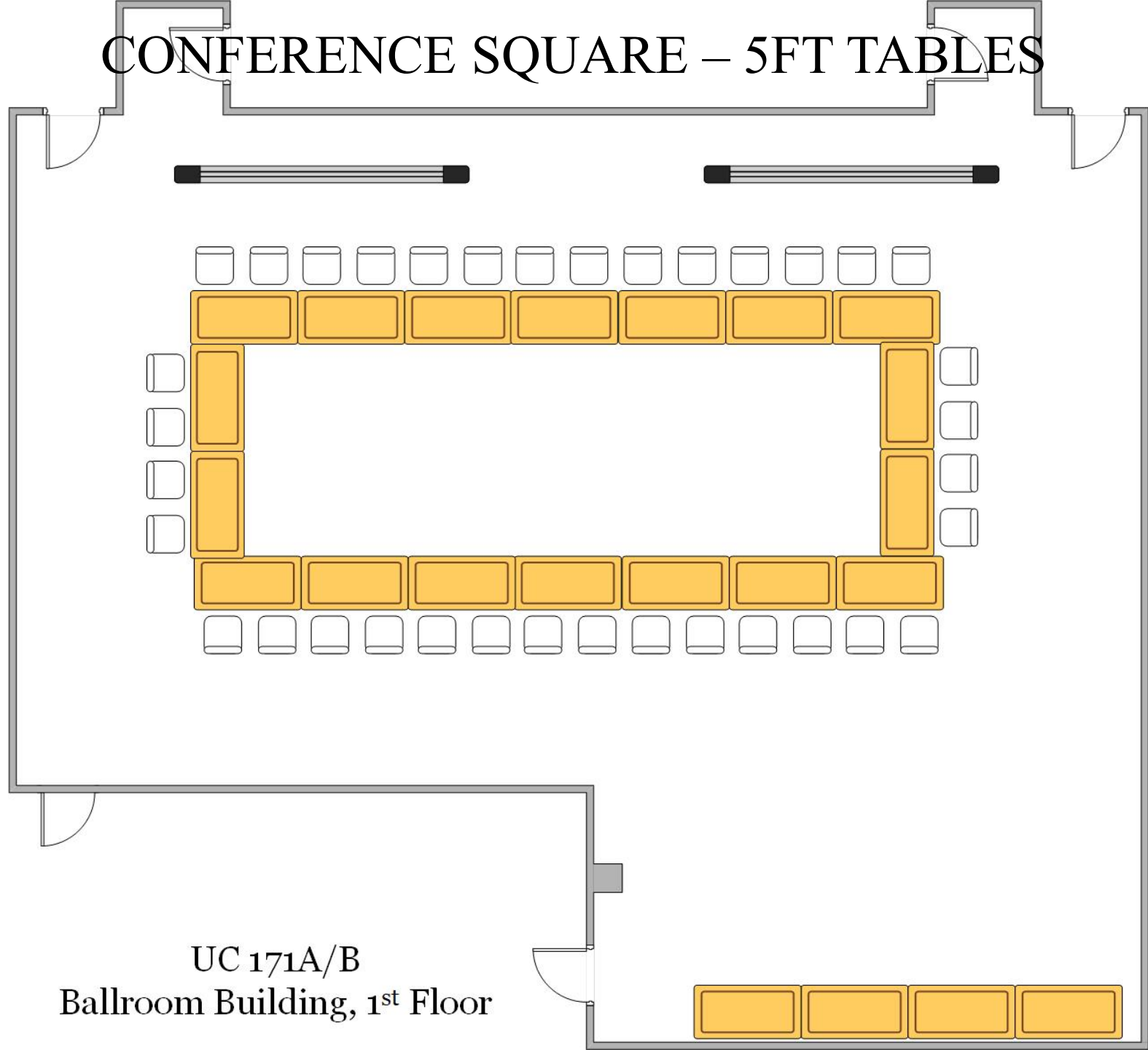

UC 171A/B
Ballroom Building, 1st Floor

CONFERENCE SQUARE – 6FT TABLES

171AB
Capacity - 24

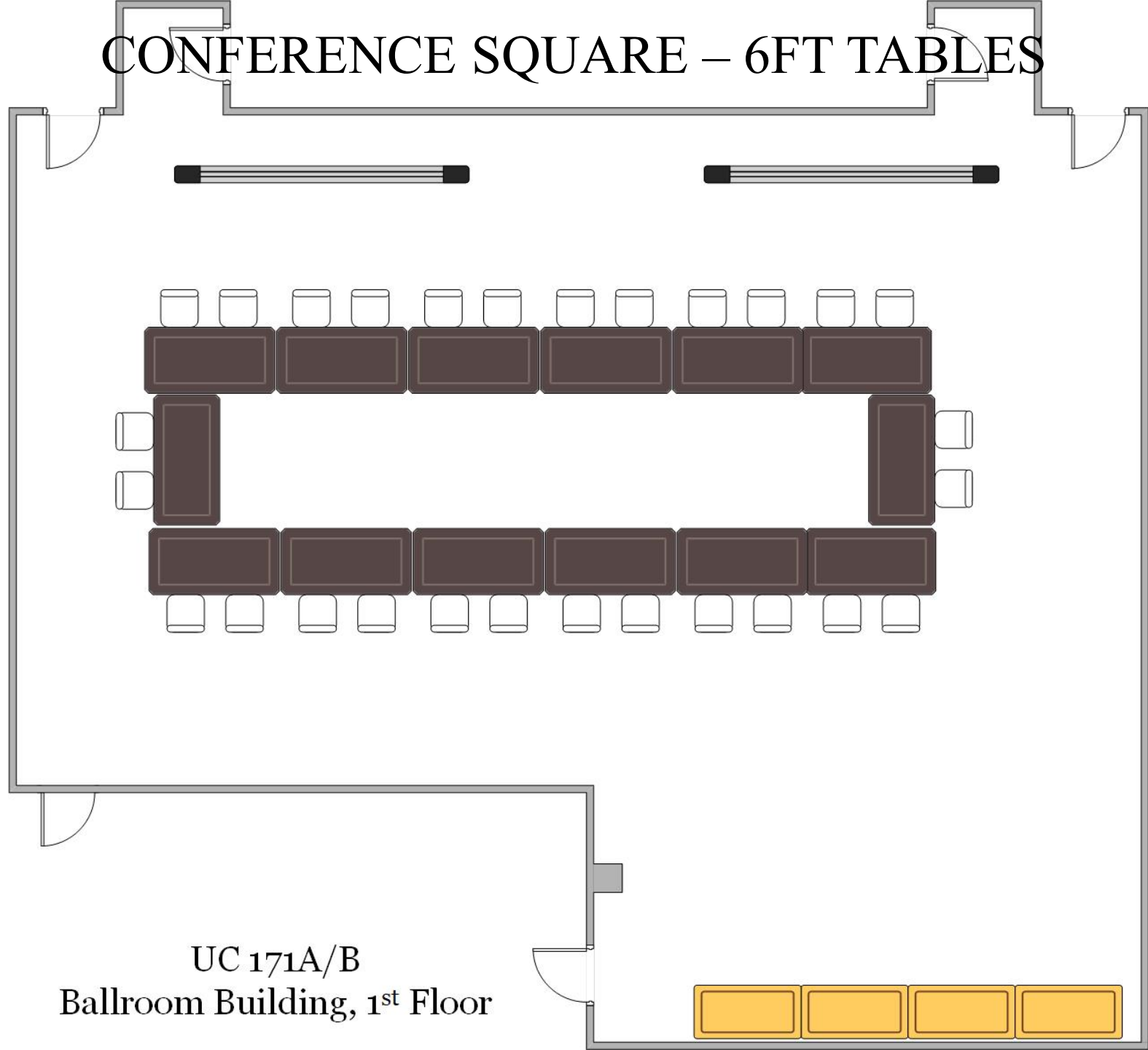

UC 171A/B
Ballroom Building, 1st Floor

CONFERENCE SQUARE

Diagram shows
BALLROOM A,
BALLROOM B, and
BALLROOM C as
separate rooms

Ballroom A
Capacity – 40

Ballroom B
Capacity – 40

Ballroom C
Facing North
Capacity – 48

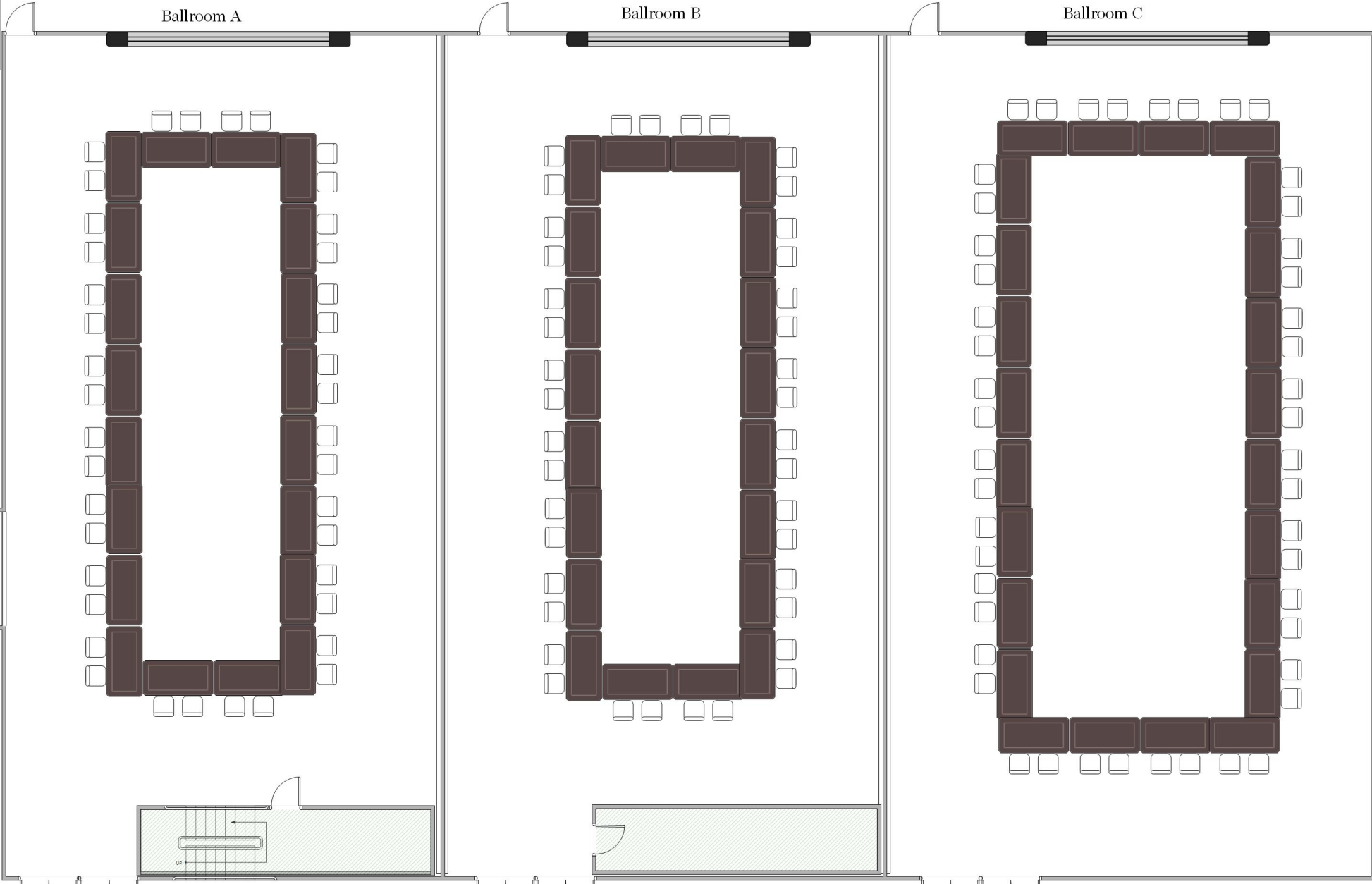

CONFERENCE SQUARE

Diagram shows
BALLROOM AB as a
separate room

Ballroom AB
Capacity – 64



CONFERENCE SQUARE

Diagram shows
BALLROOM AB as a
separate room

Ballroom A

Ballroom B

Ballroom C

Ballroom BC
Capacity – 68

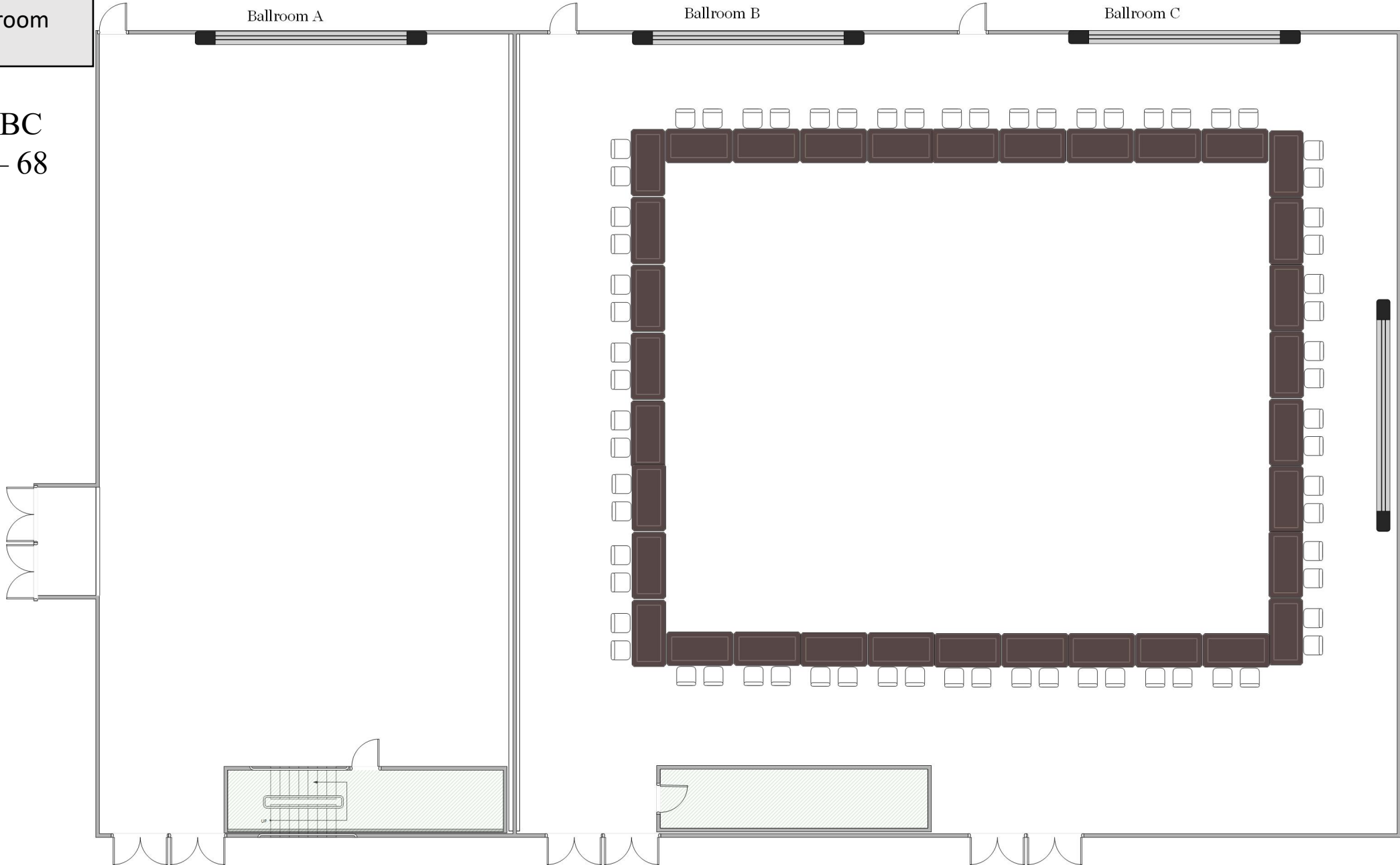

CONFERENCE SQUARE

Ballroom A

Ballroom B

Ballroom C

Ballroom ABC
Capacity – 84

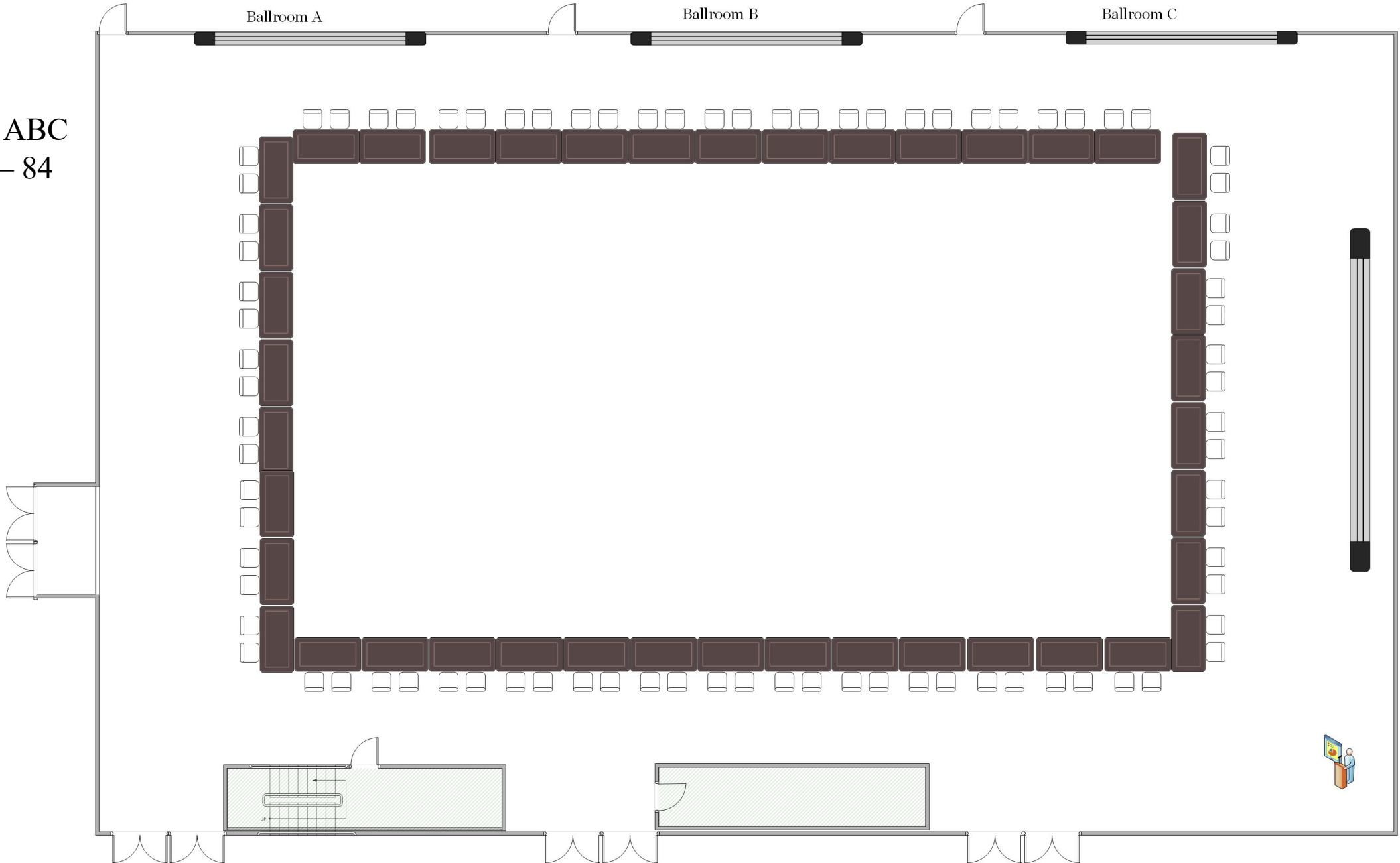

Additional Spaces

- UC 202 – capacity 10 + lecture for 20
 - Tables and chairs cannot be moved in this space
- UC 216 – capacity 49
 - Tables and chairs cannot be moved in this space
- UC 325 – capacity 18
 - Tables and chairs cannot be moved in this space
- UC 327 – capacity 12
 - Tables and chairs cannot be moved in this space